

PROJECT PROPOSED BASEMENT + GROUND + 8 STORIED AND SINGLE STORIED RESIDENTIAL BUILDING.

NAME OF OWNERS: 1. SAGARMATHA PROJECTS PRIVATE LIMITED BANSKOTA
 2. SRI NARESH AGARWAL
 3. SRI SHASHI AGARWAL
 4. SRI ROHIT AGARWAL
 5. SRI RAHUL AGARWAL
 6. AISHWARIYA AGARWAL
 7. NIKITA AGARWAL
 8. SRI TILAK BANSKOTA

LOCATION : MATIGARA, SILIGURI

LAND SCHEDULE:-
 MOUZA - GOURCHARAN
 J.L. NO. - 81
 SHEET NO. - 1
 TOUZI NO. - 91
 PARAGANA - PATHARGHATA
 R.S. PLOT NO. - 54,59,62,66
 L.R. PLOT NO. - 43,44,45,49,52,65
 L.R. KHATAN NO. - 6190,6178,6183,6187,6182, 6175,6204,6173,6192,6202,6177, 6196,6203,6174,6191,6189,6201, 6200,6188,6185,6176,5443

P.S. - MATIGARA
DIST. - DARJEELING
LATITUDE - 23°43'53.57" N
LONGITUDE - 88°22'59.01" E

GENERAL NOTES:

1. ALL DIMENSIONS ARE IN MILLIMETRES.
2. ONLY WRITTEN DIMENSIONS ARE TO BE FOLLOWED.
3. ALL EXTERNAL WALL SHALL BE 200MM THICK AND INTERNAL WALL SHALL BE 125 MM. THICK.
4. ALL MASONRY WORK WILL BE CARRIED OUT WITH FLY ASH BASED A.A.C. BLOCK.
5. SOLAR, WIND OR OTHER RENEWABLE ENERGY SHALL BE INSTALLED TO MEET ELECTRICITY GENERATION EQUIVALENT TO AT LEAST 1% OF THE CONNECTED LOAD OR AS PER THE STATE /LOCAL BUILDING BYE-LAWS REQUIREMENT, WHICHEVER IS HIGHER.

DECLARATION OF OWNER'S:-

I DO HEREBY DECLARE THAT THE BUILDING PROPOSED FOR CONSTRUCTION SHALL BE SUPERVISED BY THE B.A.L.B.S. SIGNING THE BUILDING PLAN APPLICATION OR IN HIS ABSENCE BY ANY OTHER B.A.L.B.S. OF THE APPROPRIATE CATEGORY AND AS APPROVED BY THE AUTHORITY.

Tilak Banskota
 Signature of Owner

DECLARATION OF STRUCTURAL ENGINEER

THE STRUCTURAL DESIGN AND DRAWING OF BOTH FOUNDATION AND SUPER STRUCTURE OF THE BUILDING HAS BEEN MADE BY ME CONSIDERING ALL POSSIBLE LOADS INCLUDING THE SEISMIC LOAD AS PER THE "NATIONAL BUILDING CODE" OF INDIA AND CERTIFIED THAT IT IS SAFE AND STABLE IN ALL RESPECT. MOREOVER I/WE SHALL BE HELD RESPONSIBLE FOR ANY STRUCTURE DAMAGE/FAILURE HAPPENED DURING CONSTRUCTION PERIOD AND THERE AFTER BEYOND DATE OF TAKING OCCUPANCY CERTIFICATE.

Sanjay Parekh
 SANJAY PAREKH
 M.E.(STRUCT.), M.E.(CONST. ENG.)
 B.C.E., P.E.(P-012302-4)
 E.S.E. NO. 10643/K.M.C.
 STRUC/ENGR/1-27/S.M.C.

SIGNATURE OF STRUCTURAL ENGINEER

DESIGNED AND CHECKED BY ME

Dr. Smita Tung
 DR. SMITA TUNG
 M.E.(P.D.)
 LIC NO. 017441 (GMC)
 E-qualified Geo-Technical Engineer

SIGNATURE OF GEO-TECHNICAL ENGINEER

DECLARATION OF ARCHITECT / L.B.S.

I DO HEREBY DECLARE THAT THE KEY PLAN, SITE PLAN AND THE BUILDING PLAN HAVE BEEN PREPARED UNDER MY SUPERVISION AND I SHALL BE RESPONSIBLE FOR THE SUPERVISION OF THE BUILDING.

Riya Biswas
 RIYA BISWAS (B.Arch)
 E.S.E. NO. 10215
 SIGNATURE OF ARCHITECT / L.B.S.

TITLE: BLOCK-2 SECTIONS, SITE PLAN, AMENITY BLOCK DETAILS

SCALE:- VARIES

DATE - 12.04.2021

SHEET NO. :- 04/05

CKD. BY:- K. K. ROY

DRAWN BY:- SAHELI/MOFIKUL

ARCHITECT:-
 GREEN ARCHITECTURE CONSULTING ENGINEERS PVT. LTD.

1ST FLOOR, B.R. AMBEDKAR COMPLEX, HILL CART ROAD, SILIGURI - 734003

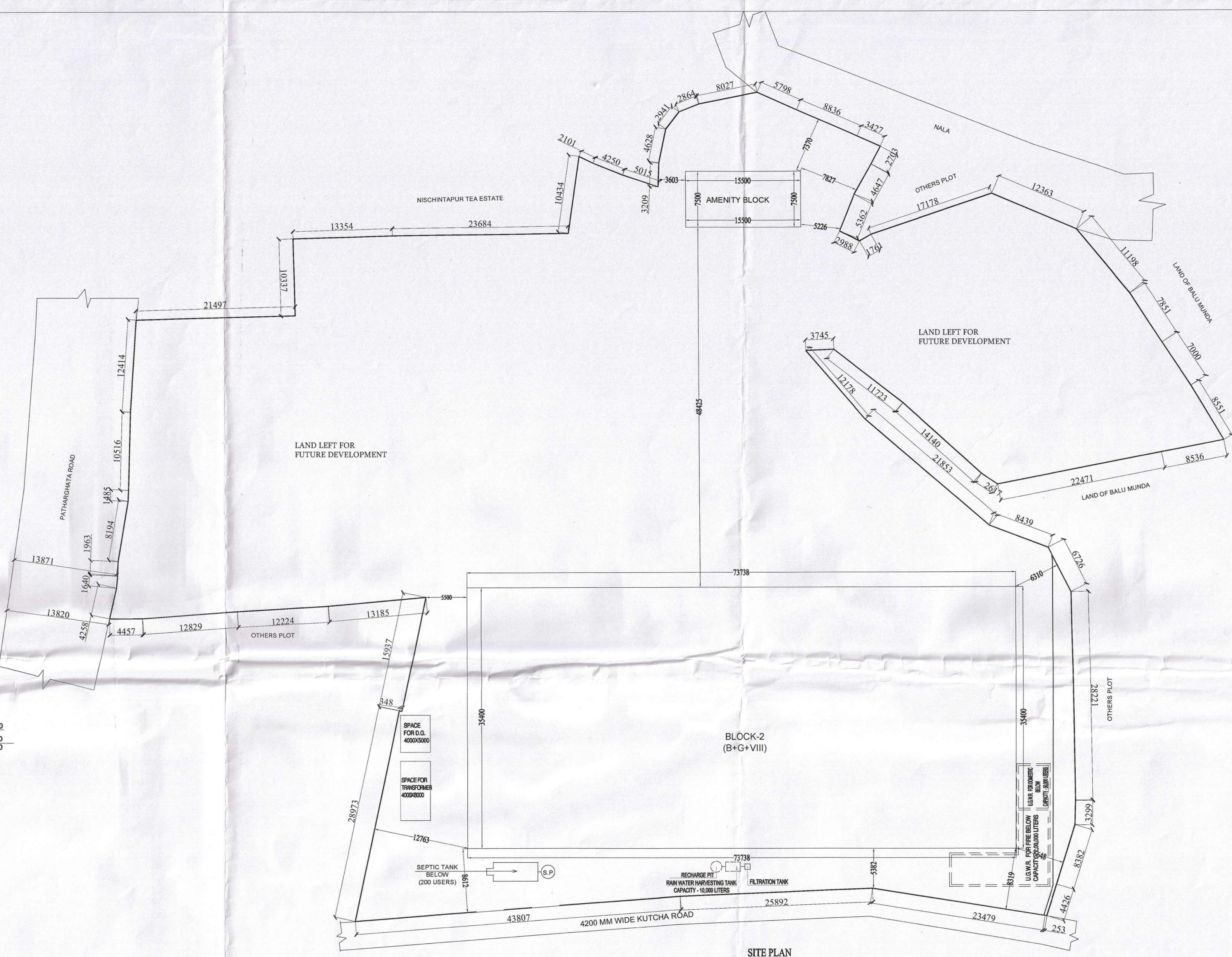
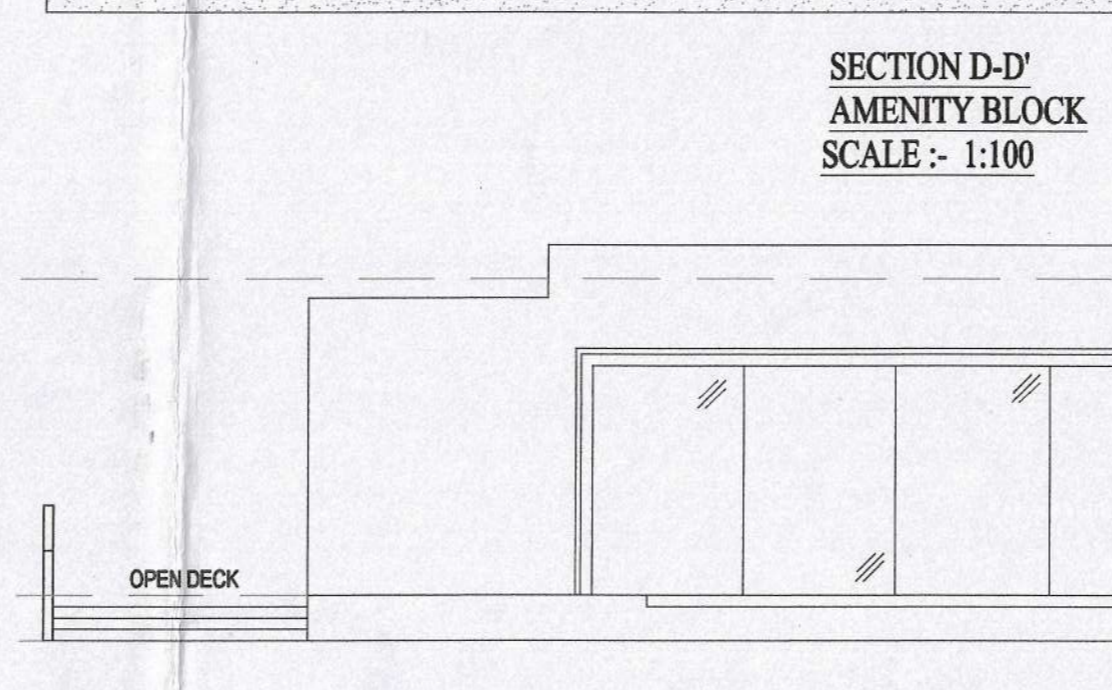
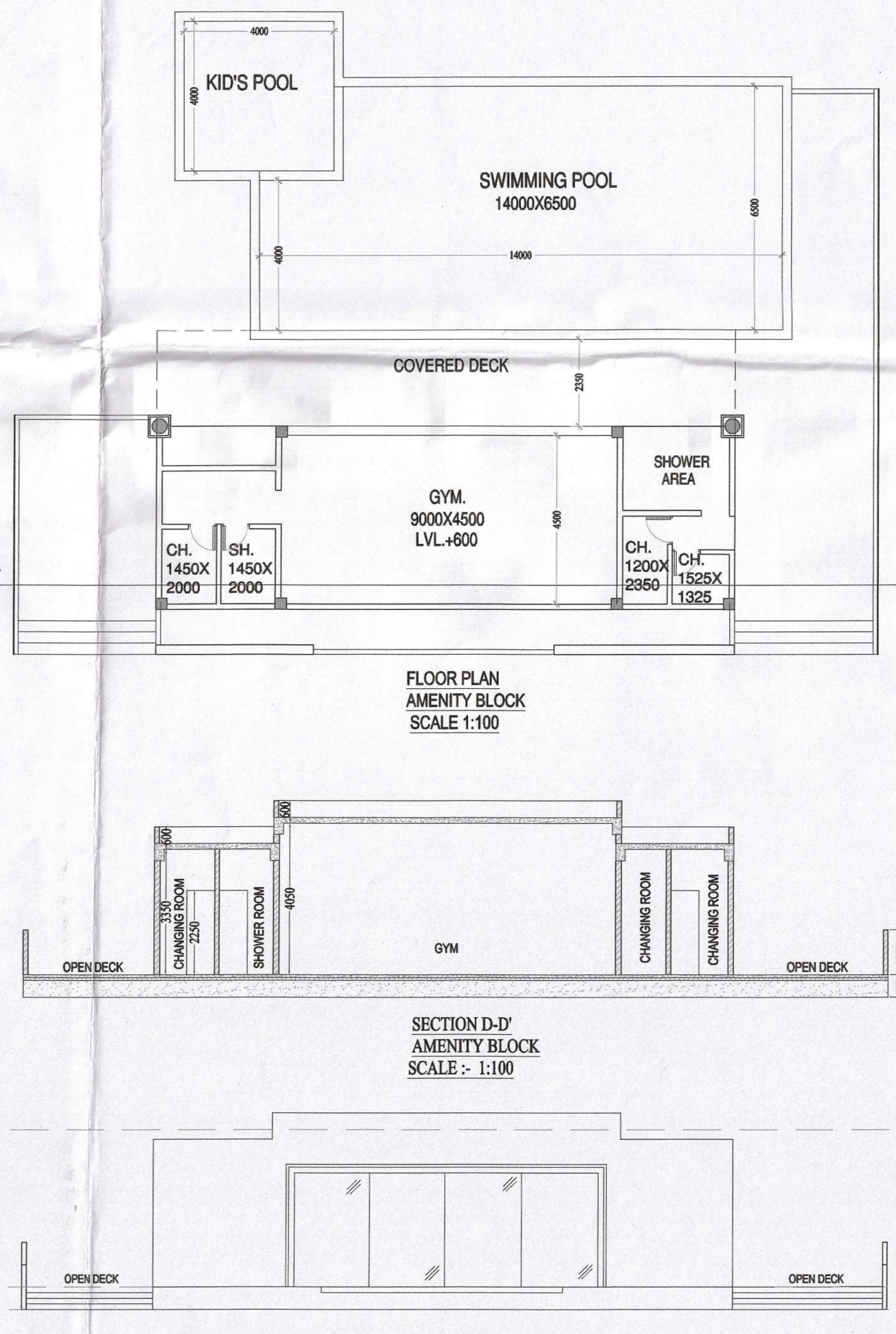
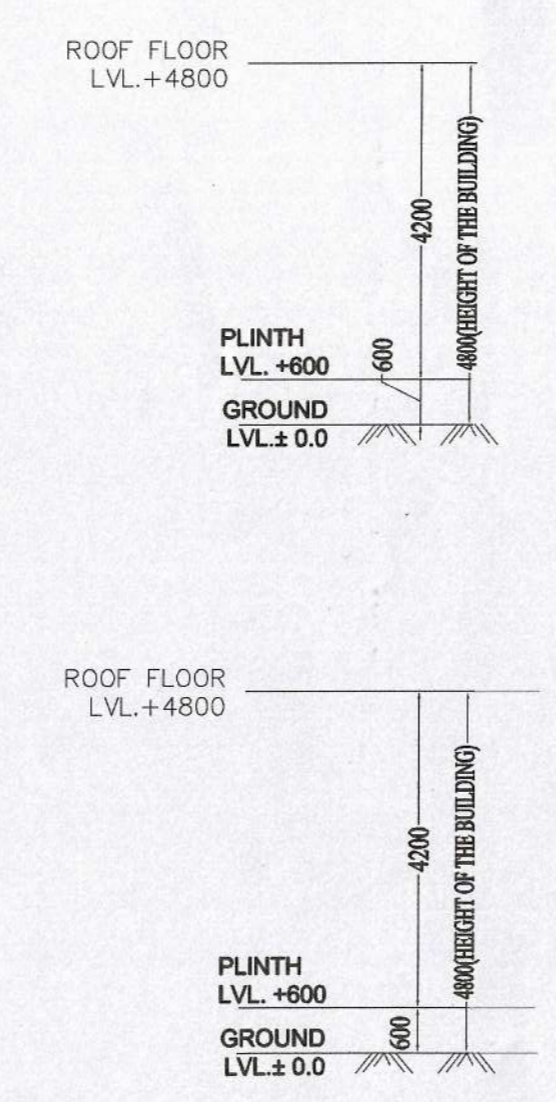
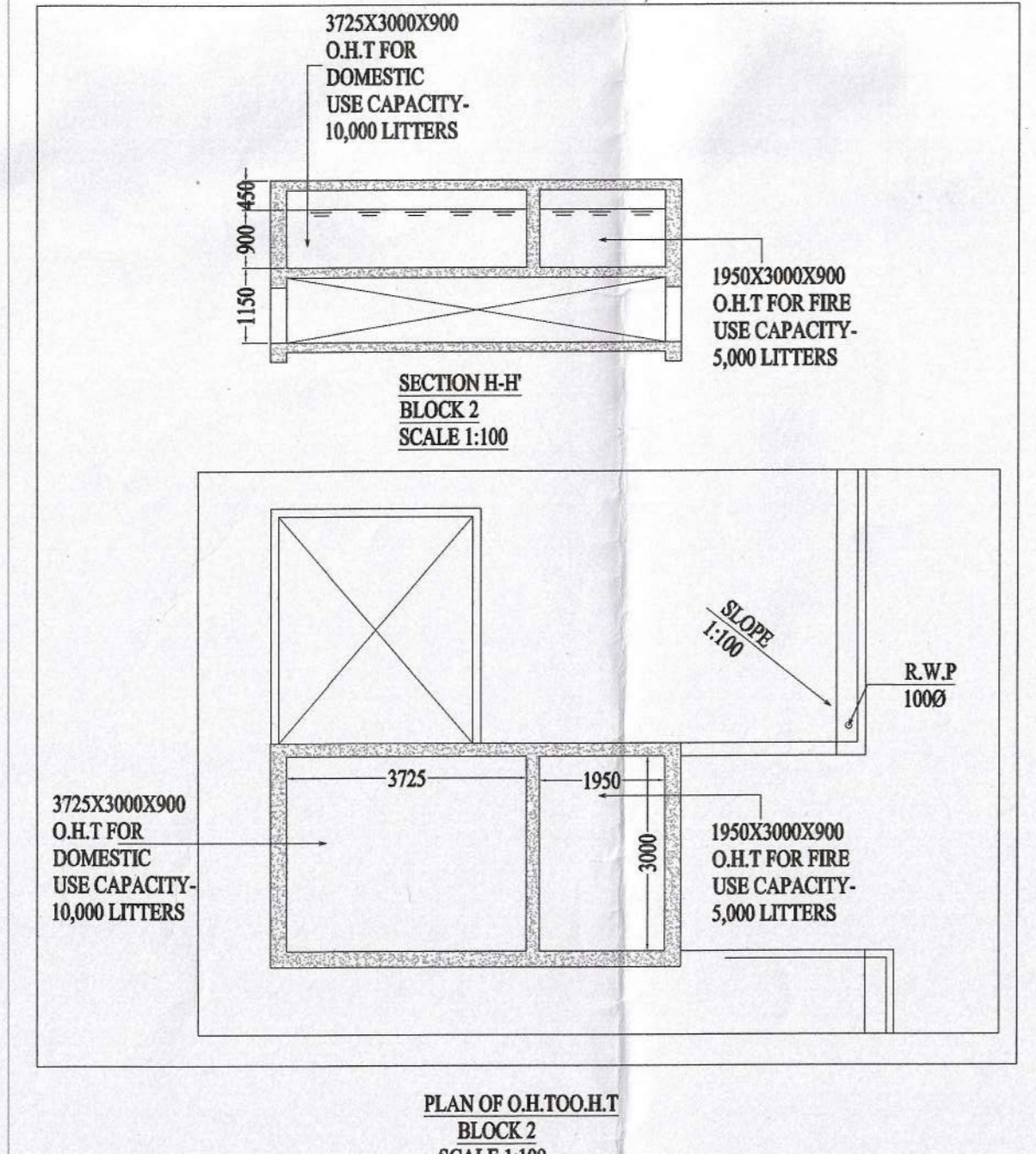
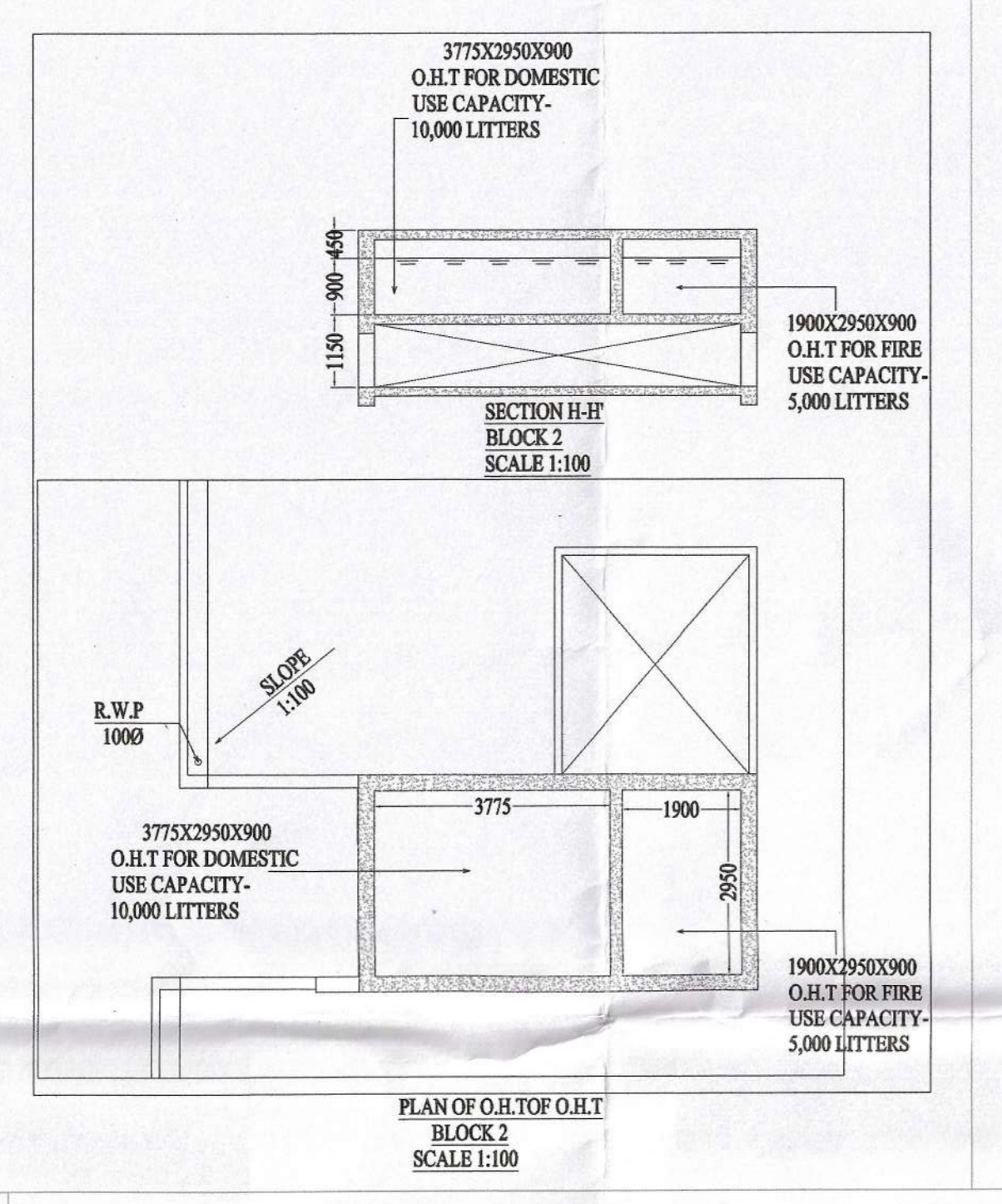
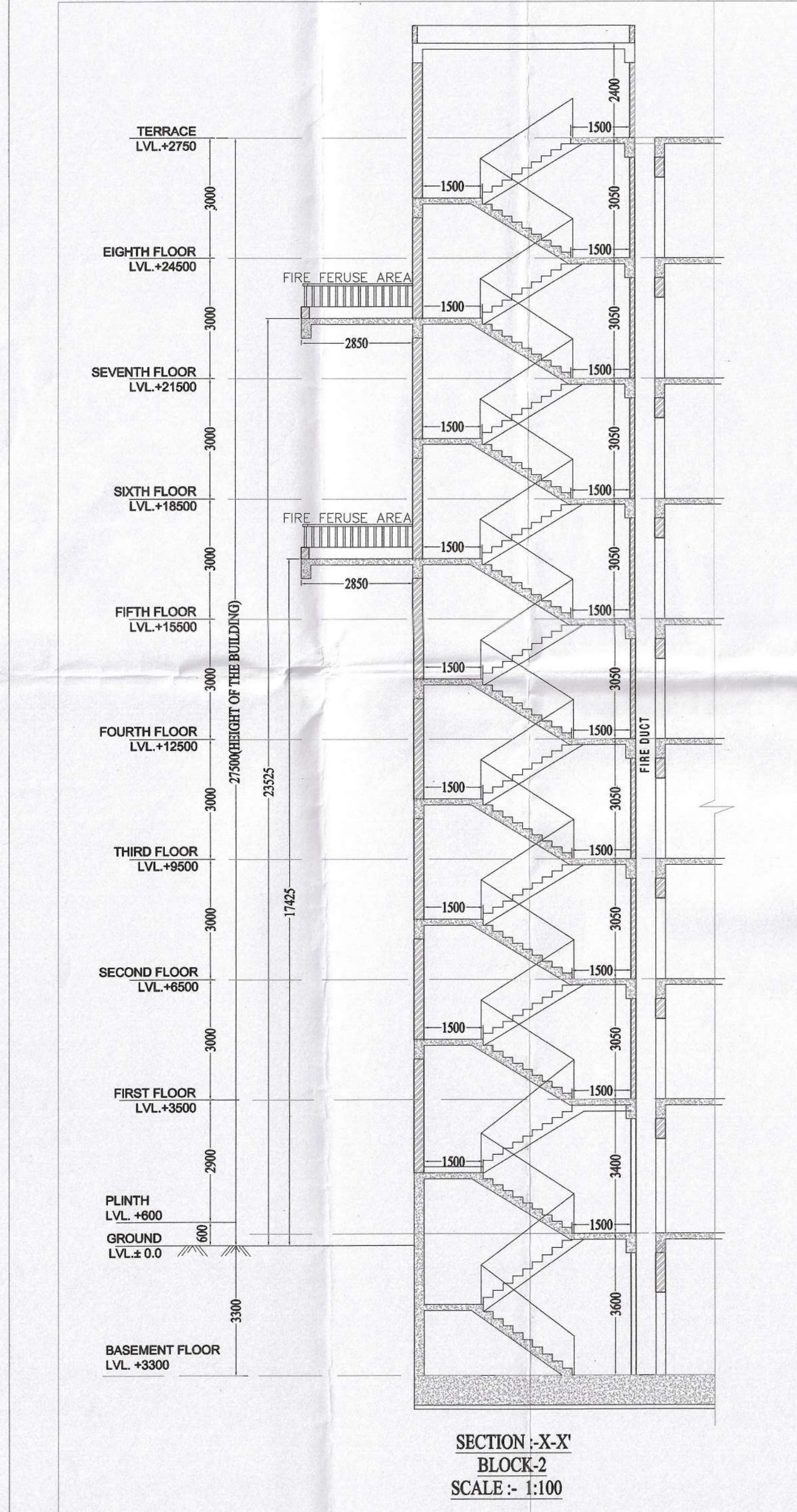

DOORS & WINDOWS SCHEDULE

DOORS	MKD	SILL	LINTEL	SIZE
D1	-	2250	1100X2250	
D2	-	2250	900X2250	
D3	-	2250	750X2250	
DA	-	2250	1800X2250	
SD1	-	2250	2075X2250	
SD2	-	2250	1250X2250	
FCD	-	2250	1100X2250	

WINDOWS	W1	W2	W3	W4	W5	W6	SW
	750	950	750	1650	750	750	750 FROM LANDING
	2250	2250	2250	2250	2250	2250	2250 FROM LANDING
	1500X1500	950X1300	750X1500	600X600	1350X1500	1200X1500	1200X1500

May be Sanctioned
[Signature]
Architect
Siliguri Mahakuma Parishad

Technically Approved
[Signature]
District Engineer
Siliguri Mahakuma Parishad
Siliguri, Dist. Darjeeling

The Construction of the Building shall be supervised by the Licensed
Engineering Surveyor/Architect signing it. Unless
otherwise approved by the Authority the permission shall remain valid
for a period of TWO YEARS.
Registration No. 672... Permission Granted/Permission granted
subject to the condition as noted in the ORDER. Building plans also
to be approved by the Matigara Panchayat Samity, before the
proposed construction undertaken.

ORDER NO. 711/MPS
DATE 30/12/2021
[Signature]
Executive Officer
Matigara Panchayat Samity
P.O. Kadamtala, Dist. Darjeeling

[Signature]
Sub Assistant Engineer (B.P.C.)
Matigara Development Block
P.O. Kadamtala, Dt. Darjeeling

APPROVED
[Signature]
Executive Officer
Matigara Panchayat Samity
P.O. Kadamtala, Dist. Darjeeling

(1)